

IRS Problem Solvers, Inc.

16800 Valley View Ave., La Mirada, CA 90638-5533

(877) 6-SOLVER / Fax (562) 404-3126

www.yourirsproblemsolvers.com • e-mail: phil@liberatorecpa.com

THE AMERICAN SOCIETY OF

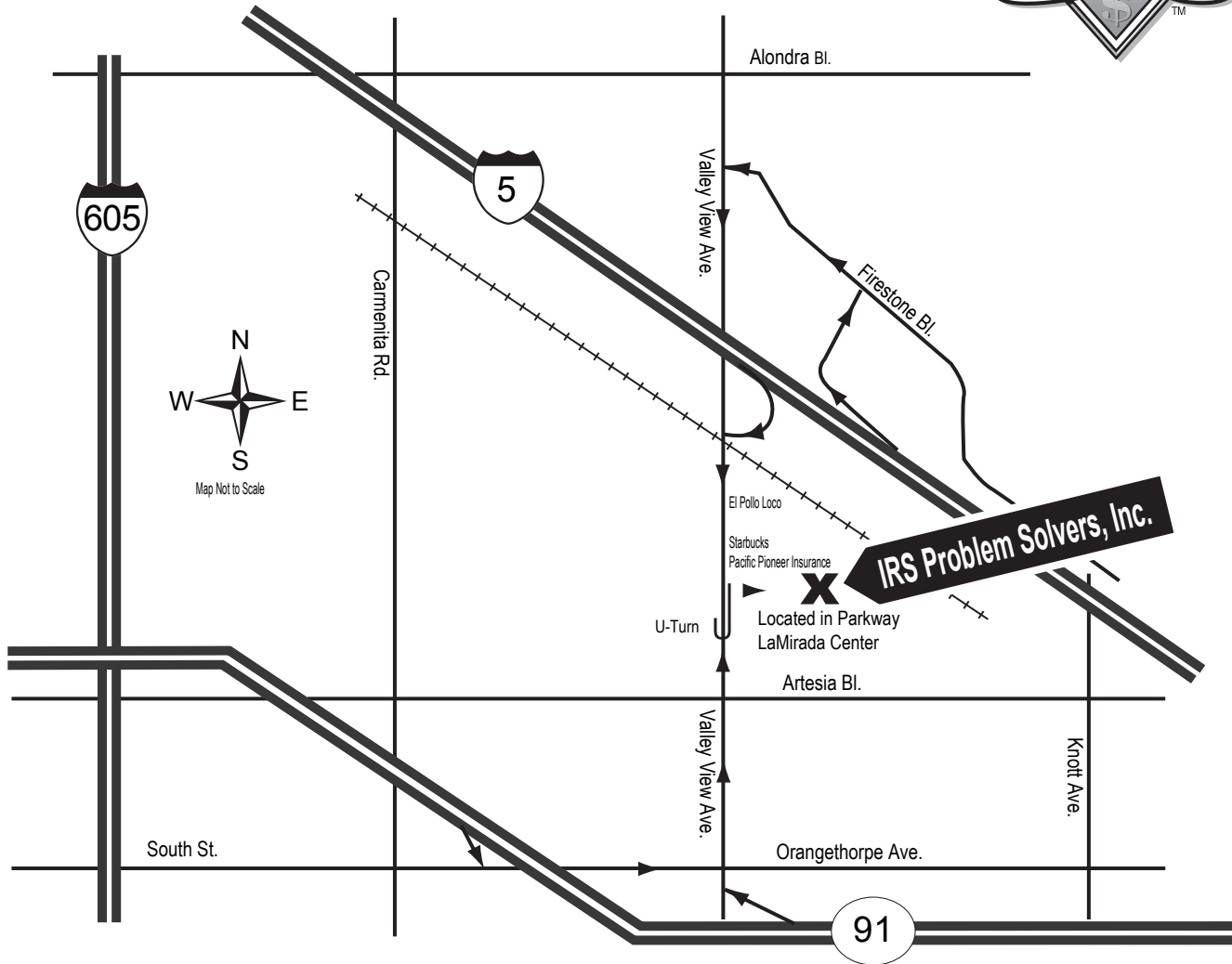

5 South (From Los Angeles County)
Exit at Valley View,
Continue right (between the two gas stations),
Turn Left on Valley View,
Pass the Railroad Crossing,
Go to the 2nd Left Hand Turn Lane,
Make a U-Turn,
Make an Immediate Right into the Parking Lot,
Go Straight Back to our Building.

91 East (From Los Angeles County)
Exit at Orangethorpe / Valley View,
Turn left on Orangethorpe,
Turn left on Valley View,
Go Straight Approximately 1-1/2 miles north,
Turn right into Parkway La Mirada,
(before Pacific Pioneer Insurance, 3 story building)
Go Straight Back to our Building.

5 North (From Orange County)
Exit Valley View,
Turn left on Firestone Blvd.,
Turn Left on Valley View,
Pass Over the 5 Freeway,
Pass the Railroad Crossing,
Go to the 2nd Left Hand Turn Lane,
Make a U-Turn,
Make an Immediate Right into the Parking Lot,
Go Straight Back to our Building.

91 West (From Orange County / Riverside County)
Exit at Valley View / Orangethorpe,
Turn right onto Valley View,
Go Straight Approximately 1-1/2 miles north,
Turn right into Parkway La Mirada,
(before Pacific Pioneer Insurance, 3 story building)
Go Straight Back to our Building.

**We're located at the Parkway La Mirada Center
16800 Valley View Ave., La Mirada, CA**